

PRX PN16 ~ PN25 Series

Pilot Operated Pressure Reducing Valve



導式減壓閥

產品特點

- ▶ 1.適用於蒸氣與水等介質
- ▶ 2.最大進口壓力 16 Bar & 25 Bar
- ▶ 3.按照出口壓力選擇可調彈簧
- ▶ 4.口徑範圍DN15~200
- ▶ 5.耐溫範圍0~285°C
- ▶ 6.最大減壓比 20:1
- ▶ 7.德標美標國標法蘭連接 皆有

PRODUCT INTRODUCTION

- ▶ 1. Especially suitable for steam and water.
- ▶ 2. Max inlet pressure: 16 bar, 25 bar.
- ▶ 3. Outlet pressure (Springs pressure setting range)
Yellow: 0.2 to 3 bar ; Blue: 2.5 to 7 bar ; Red: 6 to 12 bar.
- ▶ 4. Diameter: 15-200 mm.
- ▶ 5. Media temperature: 0-285 °C.
- ▶ 6. Max rate inlet pressure/outlet pressure: 20:1.
- ▶ 7. DIN, ANSI, GB.

材質表

CONSTRUCTION OF MATERIALS

部件	Parts	Material
閥體 閥蓋	body ,cover	WCB
閥座	Valve Seat	2Cr13
閥桿	Valve Stem	2Cr13
主隔膜	Main Diaphragm	Stainless Steel
上隔膜	Upper Diaphragm	Brass + S.S
調整彈簧	Adjustment Spring	60Si2Mn
閥座彈簧	Valve Return Spring	Stainless Steel

依照出口壓力選用彈簧

Adjustment Spring Choosing by Outlet Pressure



黃色彈簧 Yellow Spring 0.2 barg ~ 0.3 barg
 藍色彈簧 Blue Spring 2.5 barg ~ 7.0 barg
 紅色彈簧 Red Spring 6.0 barg ~ 12 barg

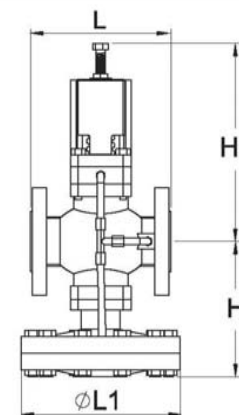
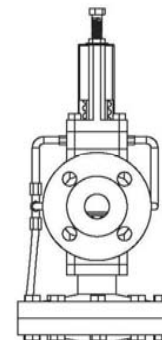
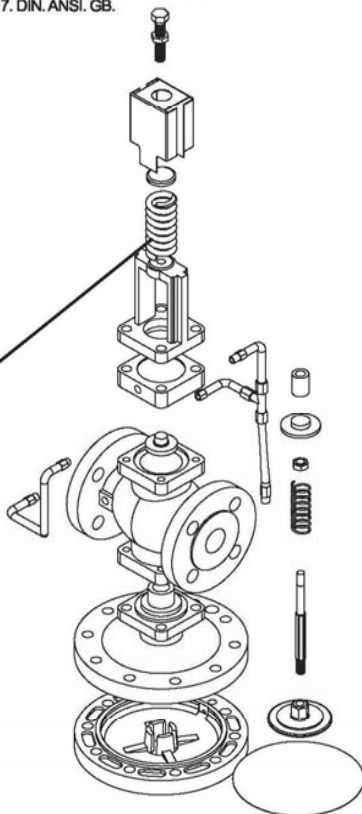

PRX Pressure Reducing Valve Dimension:

DN	PN16 Main connection size									
	L	H1	H	L1	D	D1	D2	b	f	n-φd
DN15	147	235	145	185	95	65	45	16	2	4-φ14
DN20	154	235	145	185	105	75	58	18	2	4-φ14
DN25	160	235	145	207	115	85	68	18	2	4-φ14
DN32	180	235	145	207	140	100	78	18	2	4-φ18
DN40	200	240	180	255	150	110	88	18	3	4-φ18
DN50	230	240	183	255	165	125	102	20	3	4-φ18
DN65	250	295	200	320	185	145	122	20	3	4-φ18
DN80	310	232	230	350	200	160	138	20	3	8-φ18
DN100	350	320	240	380	220	180	158	20	3	8-φ18
DN125	400	352	315	430	250	210	188	22	3	8-φ18
DN150	450	364	334	455	285	240	212	22	3	8-φ22
DN200	500	384	354	510	340	295	268	24	3	12-φ22

DN	PN25 Main connection size									
	L	H1	H	L1	D	D1	D2	b	f	n-φd
DN15	147	235	145	185	95	65	45	16	2	4-φ14
DN20	154	235	145	185	105	75	58	18	2	4-φ14
DN25	160	235	145	207	115	85	68	18	2	4-φ14
DN32	180	235	145	207	140	100	78	18	2	4-φ18
DN40	200	240	180	255	150	110	88	18	3	4-φ18
DN50	230	240	183	255	165	125	102	20	3	4-φ18
DN65	250	295	200	320	185	145	122	22	3	4-φ18
DN80	310	232	230	350	200	160	138	24	3	8-φ18
DN100	350	320	240	380	235	190	162	24	3	8-φ22
DN125	400	352	315	430	270	220	188	26	3	8-φ26
DN150	450	364	334	455	300	250	218	28	3	8-φ26
DN200	500	384	354	510	360	310	278	30	3	12-φ26