

3 Way Ball Valve Screwed End

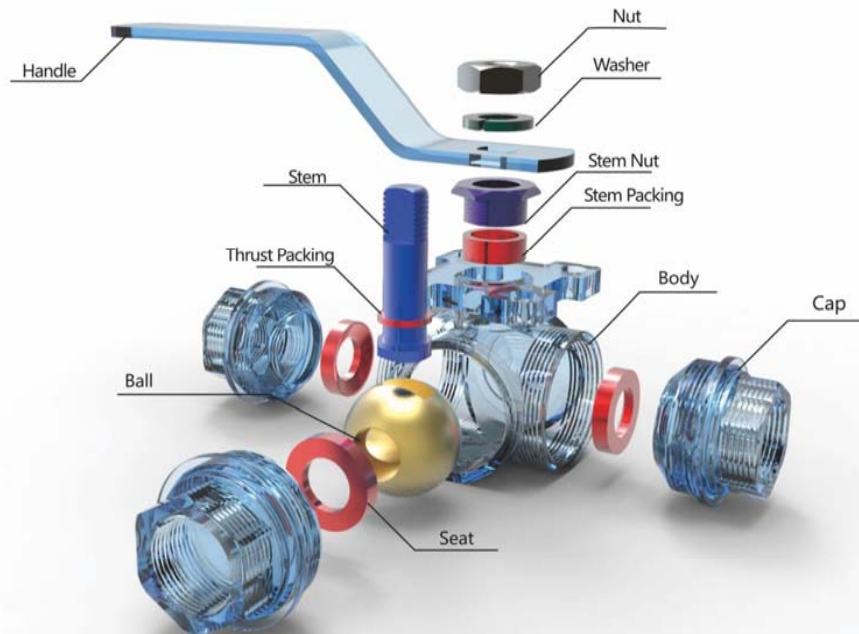

三通絲口球閥

■ EXPLOSION DRAWING 爆炸圖



FEATURES 特點

- ▶ Pipe thread in accordance with ANSI B2.1, BS 21:1973,
- ▶ DIN 259/2999, ISO 228
- ▶ Pressure rating: 1000 PSI
- ▶ Investment casting body and cap
- ▶ Blow-out proof stem
- ▶ ISO 5211 mounting pad
- ▶ Reduced port
- ▶ L-port / T-port

OPTION 選項

- ▶ Locking device
- ▶ Anti-static device
- ▶ SEATS/PACKING: R-PTFE/GRAPHITE

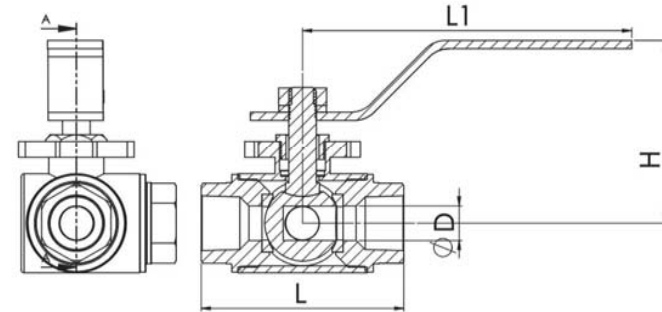

■ MATERIAL LIST 材質表

ITEM	部件	PART	MATERIALS					
			304	304L	316	316L	WCB	
1	外六角螺母	Nut	A193 B8/Customize					A193 B7
2	外六角螺栓	Bolt	A193 B8/Customize					A193 B7
3	填料壓蓋	Gland	A351-CF8	A351-CF3	A351-CF8M	A351-CF3M	A216-WCB	
4	中道墊片	Gasket	PTFE Or Optional (See Page4)					
6	填料	Packing	PTFE Or Graphite					
5	閥蓋	CAP	A351-CF8	A351-CF3	A351-CF8M	A351-CF3M	A216-WCB	
7	閥座	Seat	PTFE Or Optional (See Page4)					
8	球體	Ball	A182 F304	A182 F304L	A182 F316	A182 F316L	A276-420	
9	止退墊	Thrust Packing	PTFE Or Optional (See Page4)					
10	O型圈	O Ring	Viton / NBR					
11	閥杆	Stem	A182 F304	A182 F304L	A182 F316	A182 F316L	A276-420	
12	閥體	Body	A351-CF8	A351-CF3	A351-CF8M	A351-CF3M	A216-WCB	

■ DIMENSION 尺寸表

SIZE	D	L	H	L1
1/4"	11	70	59	105
3/8"	11	70	59	105
1/2"	12.5	70	59	112
3/4"	20	80	59	112
1"	25	86	67.5	118
1-1/4"	32	118	73	145
1-1/2"	38	130	88	170
2"	50	144	94	170