

3-PC Ball Valve Screwed End



三片式絲口球閥

FEATURES 特點

- ▶ Pipe thread in accordance with ANSI B2.1, BS 21:1973,
- ▶ DIN 259/2999, ISO 228
- ▶ Pressure rating: 1000 PSI
- ▶ Investment casting body and cap
- ▶ Blow-out proof stem
- ▶ ISO 5211 mounting pad
- ▶ Screwed end/Butt weld end/Socket weld end
- ▶ Lug body

OPTION 選項

- ▶ Locking device
- ▶ Anti-static device

EXPLOSION DRAWING 爆炸圖

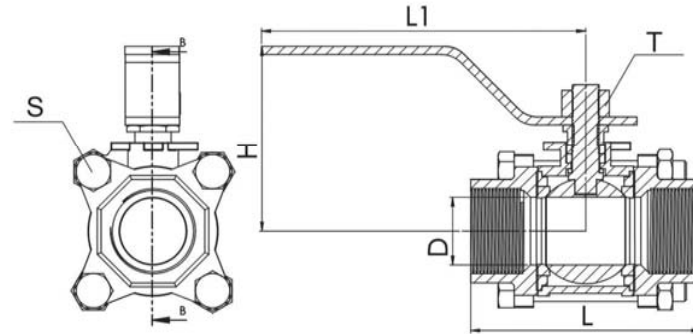
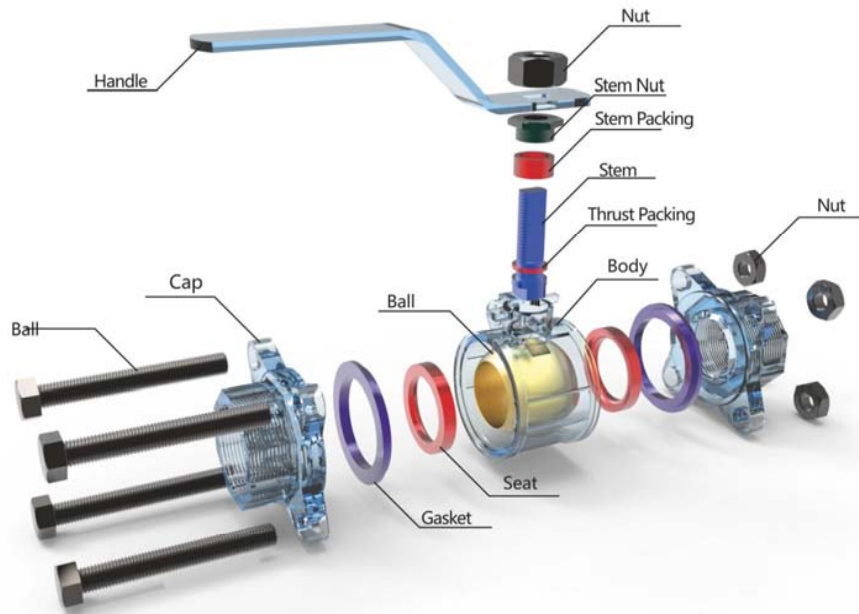

MATERIAL LIST 材質表

ITEM	部件	PART	MATERIALS				
			304	304L	316	316L	WCB
1	外六角螺母	Nut	A193 B8/Customize				
2	外六角螺栓	Bolt	A193 B8/Customize				
3	填料壓蓋	Gland	A351-CF8	A351-CF3	A351-CF8M	A351-CF3M	A216-WCB
4	中道墊片	Gasket	PTFE Or Optional (See Page4)				
6	填料	Packing	PTFE Or Graphite				
5	閘蓋	CAP	A351-CF8	A351-CF3	A351-CF8M	A351-CF3M	A216-WCB
7	閘座	Seat	PTFE Or Optional (See Page4)				
8	球體	Ball	A182 F304	A182 F304L	A182 F316	A182 F316L	A276-420
9	止退墊	Thrust Packing	PTFE Or Optional (See Page4)				
10	O型圈	O Ring	Viton / NBR				
11	閘杆	Stem	A182 F304	A182 F304L	A182 F316	A182 F316L	A276-420
12	閘體	Body	A351-CF8	A351-CF3	A351-CF8M	A351-CF3M	A216-WCB

DIMENSION 尺寸表

SIZE	D	L	L1	S	T	WT (kg)
1/4"	10	64	100	M10*1.5	M5*0.8	0.365
3/8"	10	64	100	M10*1.5	M5*0.8	0.365
1/2"	15	64	104	M10*1.5	M5*0.8	0.44
3/4"	20	70	106	M10*1.5	M5*0.8	0.57
1"	25	83	115	M12*1.75	M5*0.8	0.76
1-1/4"	32	96	128	M12*1.75	M5*0.8	0.11
1-1/2"	38	109	155	M14*2.0	M6*1.0	1.8
2"	50	121	165	M14*2.0	M6*1.0	2.8
2 1/2"	65	169	205	M16*2.5	M8*1.0	6.15
3"	80	190	215	M16*2.5	M8*1.0	9.28
4"	100	239	278	M20*3.0	M10*1.5	16.9