

# 1-PC Ball Valve Screwed End



1片式絲口球閥

### FEATURES 特點

- ▶ Pipe thread in accordance with ANSI B2.1, BS 21:1973,
- ▶ DIN 259/2999, ISO 228
- ▶ Pressure rating: 1000 PSI
- ▶ Investment casting body and insert
- ▶ Blow-out proof stem
- ▶ Reduced port

### OPTION 選項

- ▶ Wing handle
- ▶ SEATS/PACKING: R-PTFE/GRAPHITE
- ▶ Locking device

### EXPLOSION DRAWING 爆炸圖

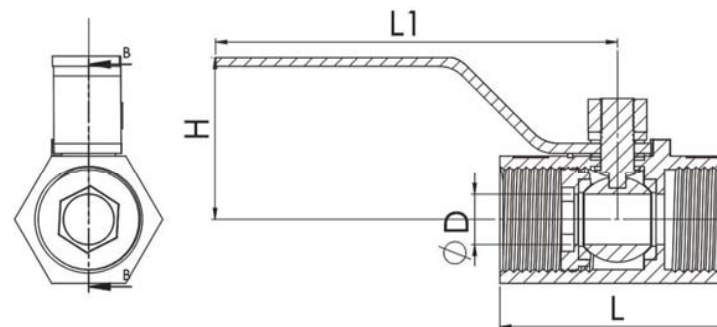
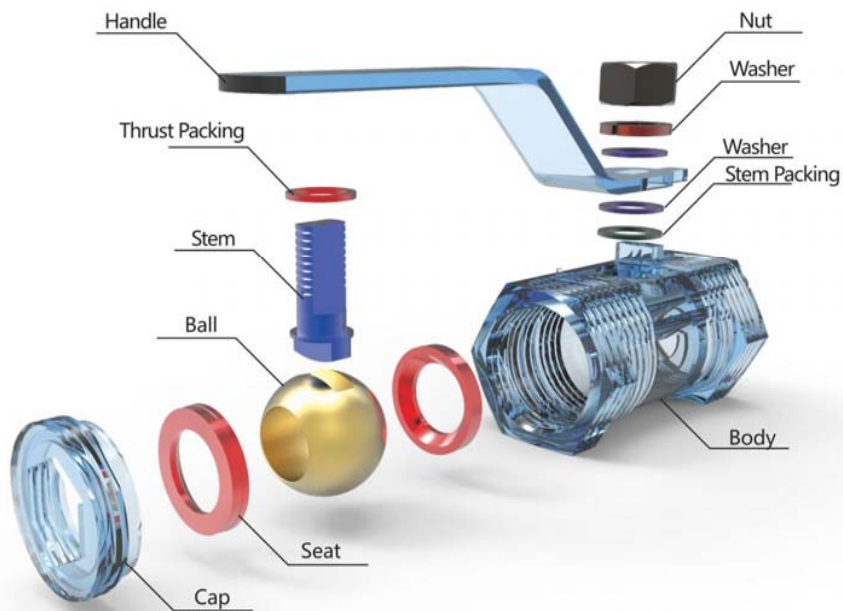

### MATERIAL LIST 材質表

ITEM	部件	PART	MATERIALS				
			304	304L	316	316L	WCB
1	外六角螺母	Nut	A193 B8/Customize				A193 B7
2	外六角螺栓	Bolt	A193 B8/Customize				A193 B7
3	填料壓蓋	Gland	A351-CF8	A351-CF3	A351-CF8M	A351-CF3M	A216-WCB
4	中道墊片	Gasket	PTFE Or Optional (See Page4)				
6	填料	Packing	PTFE Or Graphite				
5	閘蓋	CAP	A351-CF8	A351-CF3	A351-CF8M	A351-CF3M	A216-WCB
7	閘座	Seat	PTFE Or Optional (See Page4)				
8	球體	Ball	A182 F304	A182 F304L	A182 F316	A182 F316L	A276-420
9	止退墊	Thrust Packing	PTFE Or Optional (See Page4)				
10	O型圈	O Ring	Viton / NBR				
11	閘杆	Stem	A182 F304	A182 F304L	A182 F316	A182 F316L	A276-420
12	閘體	Body	A351-CF8	A351-CF3	A351-CF8M	A351-CF3M	A216-WCB

### DIMENSION 尺寸表

SIZE	D	L	H	L1
1/4"	7	39	26	68
3/8"	7	45	31	77
1/2"	9.2	50	44	85
3/4"	12.5	60	46	85
1"	15	73	54	103
1-1/4"	20	78	58	103
1-1/2"	25	90	66	125
2"	32	100	72	125